

	Metric (mm)	Decimal (in.)
A	1998.7 $\pm.008$	78.688 $\pm.008$
C	46.8 $\pm.020$	1.844 $\pm.008$
D	82.6 $\pm.020$	3.250 $\pm.008$
E	101.6 $\pm.020$	4.000 $\pm.008$
F	117.5 $\pm.020$	4.625 $\pm.008$
G	130.2 $\pm.020$	5.125 $\pm.008$
M	68.9 $\pm.025$	2.719 $\pm.010$
N	85.7 $\pm.020$	3.375 $\pm.008$
O	263.5 $\pm.020$	10.375 $\pm.008$
P	387.4 $\pm.020$	15.250 $\pm.008$
R	21.4 $\pm.020$	0.844 $\pm.008$
S	108.0 $\pm.020$	4.250 $\pm.008$

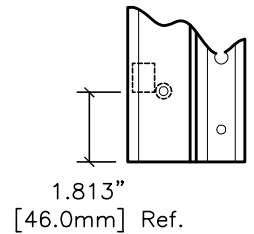

End of hinge to first bearing, both ends.

HAGER COMPANIES
 HIGHWAY 78 WEST
 P.O. BOX 3368
 OXFORD, ALABAMA 36203

780-210 79" HD

DATE 10-25-96	REV. 01-15-02	DR. KBJ	SCALE None
FILENAME z:\roton\template\standard\780-210.dwg			
DRAWING NO.		780210079HD	