

Template No. T

Rev.

Template No. T 319

Rev. '96

FULL MORTISE TEMPLATE HINGES

SIZES: 8 x 6 --- 8 x 8
(203.20 x 152.40) (203.20 x 203.20)

FOR DOORS 2 1/2 (63.50) OR MORE IN THICKNESS

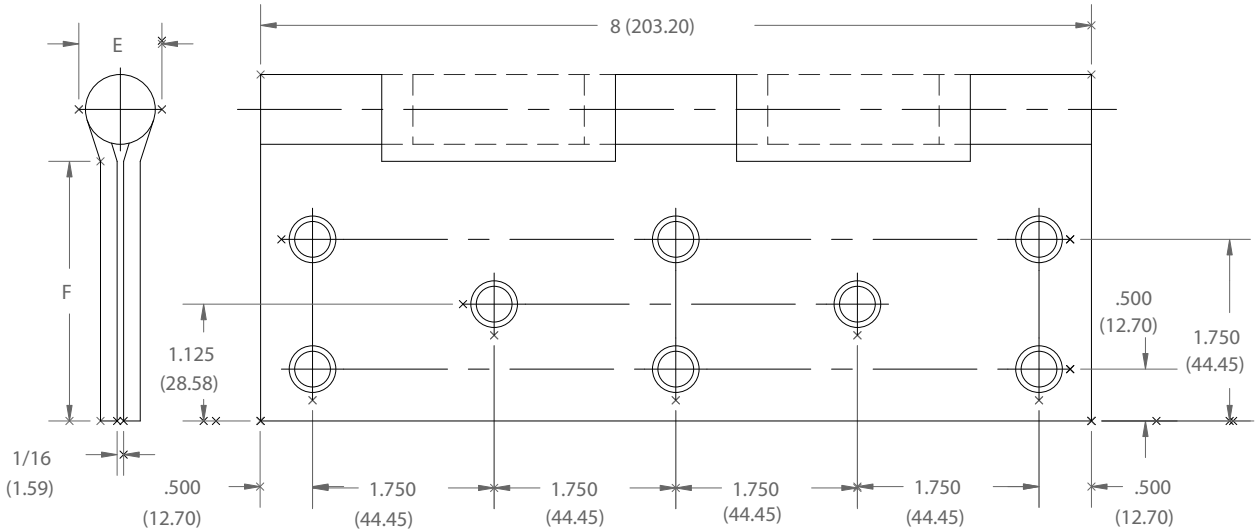

-DO NOT SCALE-

CATALOG NUMBER		METAL GAUGE	(E) KNUCKLE DIAMETER	(F) DISTANCE FROM EDGE OF LEAF TO SWAGE LINE	
STEEL HINGES	NON-FERROUS HINGES			8 x 6 (203.20 x 152.40)	8 x 8 (203.20 x 203.20)
BB1168	BB1199	.203 (5.16)	13/16 (20.64)	2 7/16 (61.91)	3 7/16 (87.31)

ALL NON-BRACKETED DIMENSIONS ARE IN INCHES, ALL BRACKETED DIMENSIONS ARE IN MILLIMETERS.

Machine Screw Size- 1/4-20 x 1/2" F.H.

Wood Screw Size- No. 14 x 1 1/2" F.H.

NOTE: Stainless steel .190 (4.83) gauge of metal and .088 (2.24) swage.



Hospital type template hinges conform to the above screw size and location. They are designated by "HT" to catalog number.

HAGER RESERVES THE RIGHT TO MAKE
DESIGN CHANGES WITHOUT NOTICE. CALL
HAGER ENGINEERING AT 1-800-325-9995
FOR LATEST REVISION DATE OF TEMPLATE.

HAGER COMPANIES
HAGER COMPANIES
1820 SOUTH STATE
ST. LOUIS, MISSOURI 63157-0300
ST. LOUIS, MISSOURI 63157-0300

Template No. T
Template No. T
319