

1. PREPARE DEVICE FOR DOOR

- 1) Hand the device to suit the door.
 - a. Loosen screw shown in figure 1
 - b. Rotate handle to position needed for desired handing
 - c. Tighten screw. DO NOT OVERTIGHTEN.

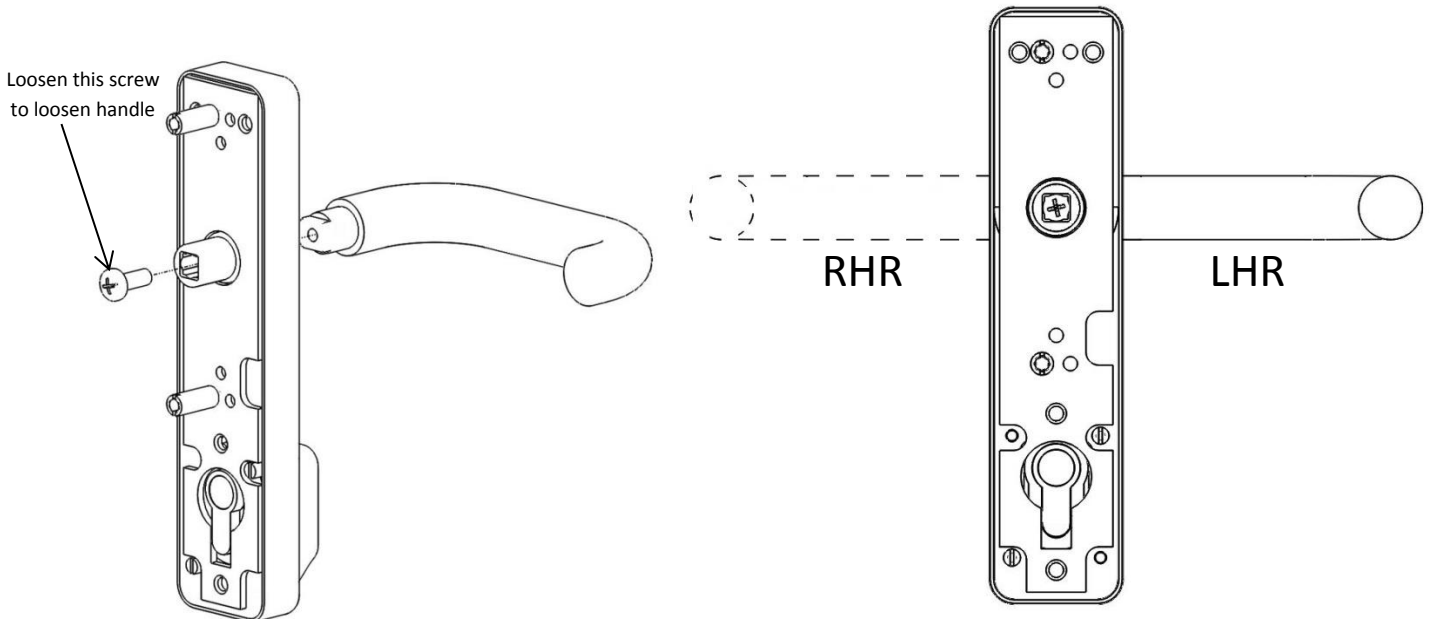

Figure 1

- 2) Install mounting standoffs and cylinder.
 - a. Install the standoffs in the proper hole based off handing and figure 2.
Note: The standoffs should always be farthest away from the hinge edge of the door.
 - b. Install cylinder with the provided screw as shown in figure 2.
 - c. Install cylinder housing
 - d. Install actuating shaft

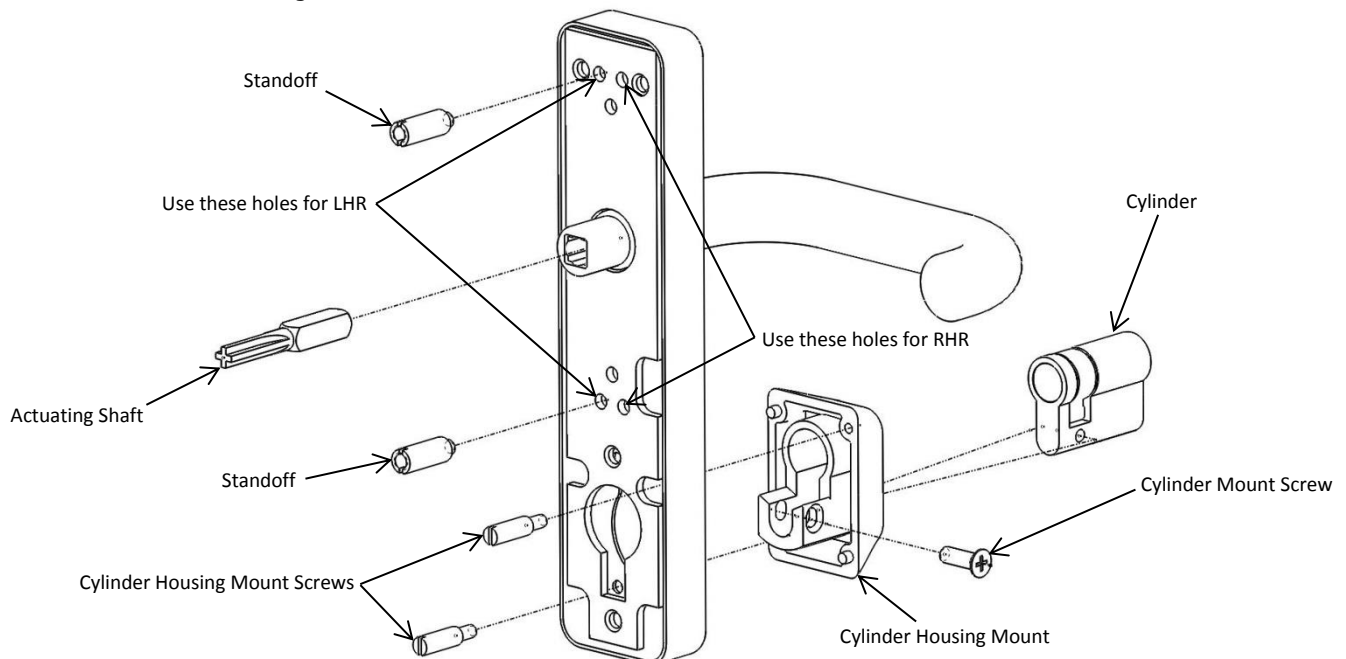

Figure 2

2. PREPARE DOOR

- 1) Using Figures 3, drill required holes for mounting.

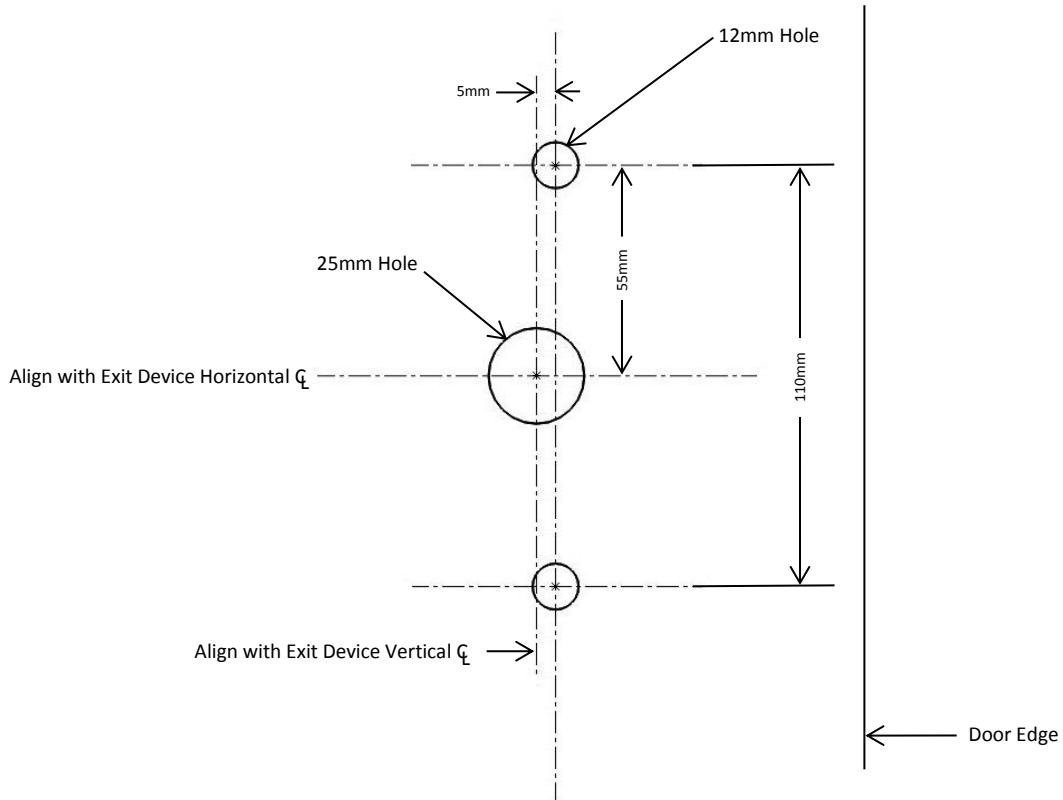

Figure 3

3. INSTALL EXIT DEVICE AND TRIM

- 1) Install trim standoffs and actuating shaft through door.
- 2) Insert actuating shaft into cam on back of exit device.
- 3) Secure with 2 screws provided with trim.
 - a) Screws may have to be cut down to fit door thickness.
- 4) Complete installation as per exit device instructions.

